

SLIDING DOOR SYSTEMS: ASSEMBLY INSTRUCTIONS

POSITION HOLDER FOR TOP TRACKS

5th edition Bremen, January 2006

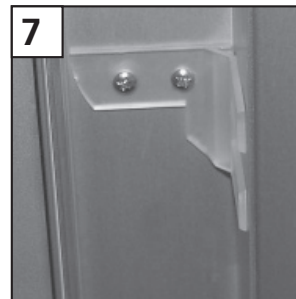
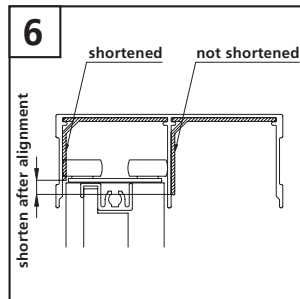
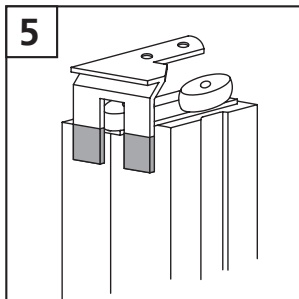
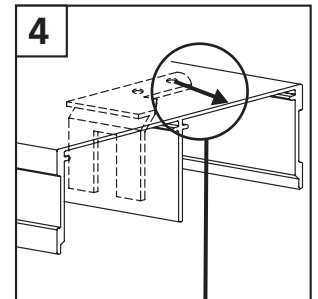
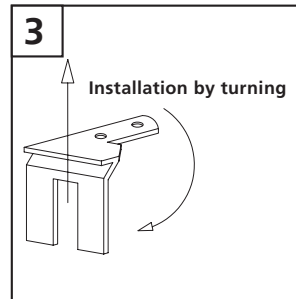
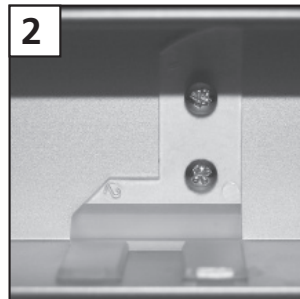
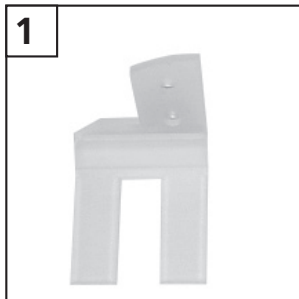

Series	Distance
400	31 mm
1500	22 mm
1000	30 mm
1001	24 mm
2000	38 mm
3000	41 mm

Important: First the bottom and top tracks must be installed and the doors adjusted. The screws are included.

1 Use the list (picture top right) to determine the required distances between the trackend (outside) and the holes in the position holder for top tracks. If a dust excluding brush is to be used, then you have to add another 3 mm to the recommended distance.

2 First mark the borings in the top track, drill holes (with a 2,5 mm drill), and screw in the holder (with a 2,9 x 6,5 mm screw). If you are installing more than two doors, the centre doors will also require a position holder for top tracks. The position (of the borings) has to be determined as follows:

3 Push the door into the desired position. Mark the position of the vertical profile in the top track (the values in the list provide the distance of the holder mark to the holes) and mark the borings.

4 Shorten the positioning for top tracks to the roller height so that it does not rub against the frame (cut off the grey ends – see pictures **5** and **6**).

5 Screw in the positionholder.

easy medium difficult *

Manufacturing
 Assembly

raumplus

*Base for the degree of difficulty is a standard sliding door without slant. This is to be classified as ,easy' in respect of production and installation.